

Spare Parts

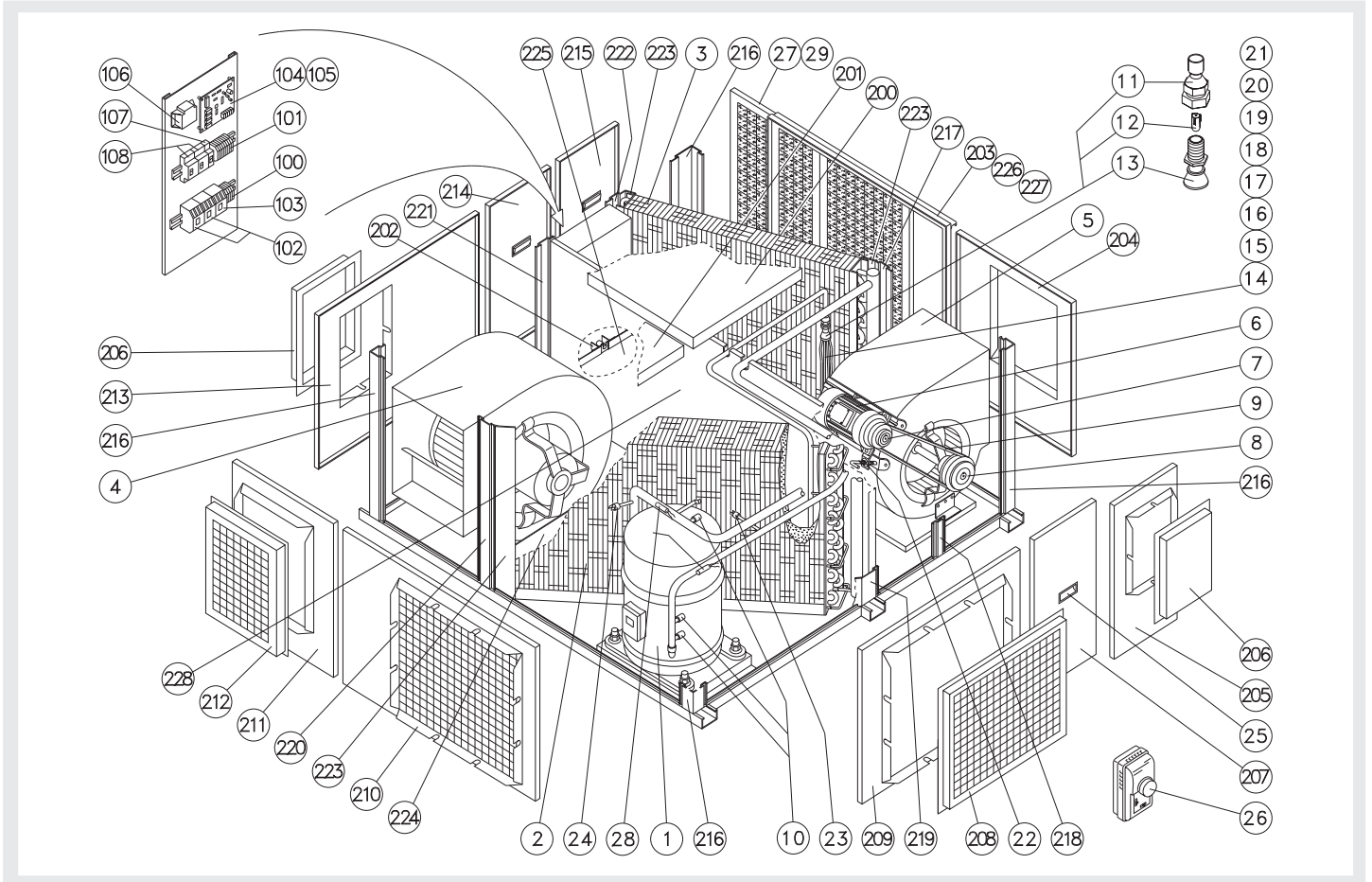

1/2

RTC-25B-38 ed. 01(10-00) R-22 (SERIAL B)



POS	ITEM	DENOMINATION	QUANTITY
			RTC-25B-38 ed.01
1	3721815	Compressor	1
2	61-6905	Condenser coil	1
3	61-6890	Evaporator coil	1
4	3795040	Motor-driven fan	1
5	3795031	Centrifugal fan	1
6	6792525	Fan motor	1
7	3761031	Speed varying pulley	1
8	3761076	Fan pulley	1
9	4918099	Fan belt	1
10	3515630	Access connection	3
11	3532001	Aeroquip connector	1
12	3520004	Restrictor	1
13	3530007	Distributor	1
14	86-8862	Capillary tube n° 1	1
15	86-8863	Capillary tube n° 2	1
16	86-8864	Capillary tube n° 3	1
17	86-8865	Capillary tube n° 4	1
18	86-8866	Capillary tube n° 5	1
19	86-8867	Capillary tube n° 6	1
20	86-8868	Capillary tube n° 7	1
21	86-8869	Capillary tube n° 8	1
22	3778539	Fan top motor support	1
23	025-17620-025	High pressure switch	1
24	025-30249-000	Low pressure switch	1
25	3787101	Handle for handling	3
26	3786024	Ambient thermostat	1
27	3737736	Air filter 695 x 410 x 25	2
28	3785064	3500 mm Sensor	2
29	3750800	Filtering material	2
100	3770994	Connecting strip	1
101	3770996	Connecting strip	1
102	6744617	Contacteur	2
103	6744652	Contacteur	1
104	6791200	Electronic board	1
105	6826810	Nylon separator	4

Spare Parts

RTC-25B-38 ed. 01(10-00) R-22 (SERIAL B)



2/2

POS	ITEM	DENOMINATION	QUANTITY
			RTC-25B-38 ed.01
106	6849855	Transformer	1
107	6776814	Automatic switch	1
108	6776702	Main switch	2
200	66-6910	Upper cover assembly	1
201	66-6911	Upper cover assembly	1
202	11-6905	Drainpipe protection	1
203	62-6883	Filter frame panel assembly	1
204	66-6915	Indoor fan panel cover	1
205	66-6914	Indoor fan panel cover	1
206	66-6938	Fan grid cover assembly	2
207	66-6916	Indoor motor panel assembly	1
208	66-6936	Air intake cover assembly	1
209	66-6923	Outdoor coil panel assembly	1
210	66-6922	Outdoor coil panel assembly	1
211	66-6921	Outdoor fan panel cover	1
212	17-10394	Outdoor air discharge panel	1
213	66-6920	Outdoor fan panel cover	1
214	66-6918	Control box panel	1
215	66-6919	Indoor coil panel assembly	1
216	66-6929	Corner assembly	4
217	66-6934	Indoor coil fan post assembly	1
218	66-6930	Motor plate post assembly	1
219	66-6931	Outdoor coil middle post assembly	1
220	66-6932	Fan post assembly and outdoor coil	1
221	66-7574	Control box post assembly	1
222	66-6933	Indoor coil control box post assembly	1
223	17-10287	Coil bracket	4
224	63-6894	Outdoor coil drain pan	1
225	63-6881	Indoor coil drain pan	1
226	17-10325	Upper filter guide	1
227	17-10326	Indoor filter guide	1
228	66-7577	Middle plate assembly	1